



ABN: 36 092 724 251  
Ph: 02 9099 7400  
(Ph: 0412 199 304)

Level 14, 135 King Street, Sydney  
Sydney 2000  
GPO Box 4103 Sydney NSW 2001  
DX 967 Sydney

Search Report

NSW LRS

Sydney

Re: - Road located between Lot 1 D.P. 1065233 and Lot C D.P. 411514 at Bowraville

An investigation of the various records available for our inspection disclosed that the road subject of your enquiry, as shown tinted yellow on the attached Cadastral Records Enquiry Report was found to originally be a Crown Road provided for in the design of the Town of Bowraville.

No evidence could be found as to the formal dedication of this road or of the transfer to the local council.

We refer you to the 1908 edition of the Town of Bowraville. This edition reflects the subject road to be a Public Road within the meaning of the Local Government Acts (? 1906). In view of this notation the road subject of your enquiry would seem to be a Council Public Road.

The information maintained at the office of LRS NSW in relation to roads is not current or accurate. Further enquiries should be directed to the Crown Lands Regional Office.

A handwritten signature in black ink, appearing to read "Mathew Hillerman".

Yours Sincerely  
Mathew Hillerman,  
(checked by Mark Groll)  
7 May 2019

**Cadastral Records Enquiry Report : Lot 1 DP 1065233**

Locality : BOWRAVILLE

Parish : BOWRA

LGA : NAMBUCCA

County : RALEIGH



NAMBUCCA SHIRE COUNCIL



0 8.5 17-25:5:34 Metres





I have asked the client if he has a title for either of these properties.

Do you know how the client may be able to confirm this? Would this be on the title as an easement/88B? He has asked for a 'Road Status Search' which I haven't come across before.

Thanks,

Zara

344870

### InfoTrack Helpdesk



Level 8, 135 King Street, Sydney NSW 2000

p

f

m

e [helpdesk@infotrack.com.au](mailto:helpdesk@infotrack.com.au)

w [www.infotrack.com.au](http://www.infotrack.com.au)





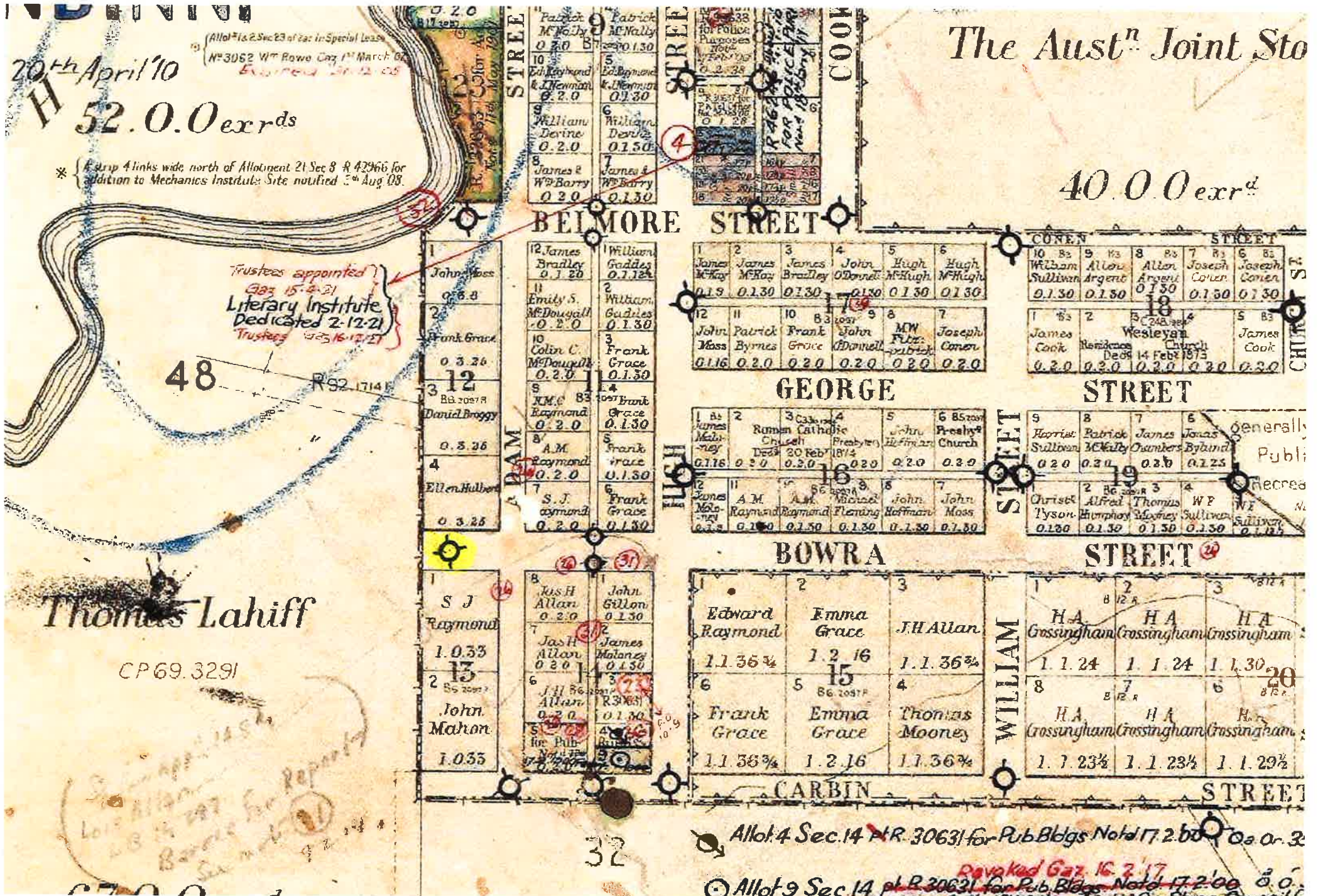



No of Lth. 08 801 T.

... and alluvium thereon or adjacent thereto, all shown  
... between the banks of such rivers, creeks and  
... between such banks and adjacent lands bordering  
... the sea or other waters, estuaries, and lagoons; 190  
... for such purposes as are hereinafter provided; and all  
... islands or parts of islands in the State, as quoted but  
... amended, now under lease, or reserved from  
... for a public purpose other than under the reser-  
... from sale under general notice of 17th April,  
... 1822, revoked 11th May, 1823.

State Forest  
in future, &  
... or B.L., &

**SALES**

At Bellingen: 23<sup>rd</sup> Sept. '91 Gaz: 23-7-91 Folio 5746

Allots: 7, 8, 9, 10, 11 Sec. 11, & 6, 7, 8 Sec. 14.

do : 8<sup>th</sup> April '96 At Bowra 27-1-97 22-1-96 25-11-96

Allots: 10 & 11 Sec. 11. Not bid for.

do : 12<sup>th</sup> April '98. Lots 6, 7, 8 Sec. 14. 29-1-98

do : do. Lots 10, 11 Sec. 11.

do : 25<sup>th</sup> Nov. '03. Lots: 1, 2, 3, 6, 7, & 8 Sec. 20.

Postponed until 12. 12. 03.

do 23-1-18 Gaz: 30-11-17, Par 223.

Bowra 1 10 13 & 3 22-8 13. Pors 283 to 296 (incl)

**Notes**

Proclaimed a Village 20<sup>th</sup> March 1885

Village boundaries shewn thus

Suburban do do

do Lands extension 12<sup>th</sup> March 1892

Parish boundary

Reserve from Sale

do do and Lease

Reserve from Occupation under Mining Act

Village Lands Reserved from Occupation for Mining Residence

or Business purposes 22<sup>nd</sup> August 1893 **Revoked Gaz 18.**

Boundaries under Police Offences Act proclaimed 31<sup>st</sup> October 1902 are

identical with Village boundaries

Part of lane in Section 8 closed vide Misc 93 440 Dep Gaz 18<sup>th</sup> Feb '93

Streets and roads which are Public Roads within the meaning of the Local Govt Acts are shewn between symbols } and }

... roads within any City, Town or Village,  
... proclaimed, ...  
... not being within a gold or silver field, are  
... exempted from ...  
... Business License, Gaz. 18th Dec., 1913.

**O R A R A**

1908



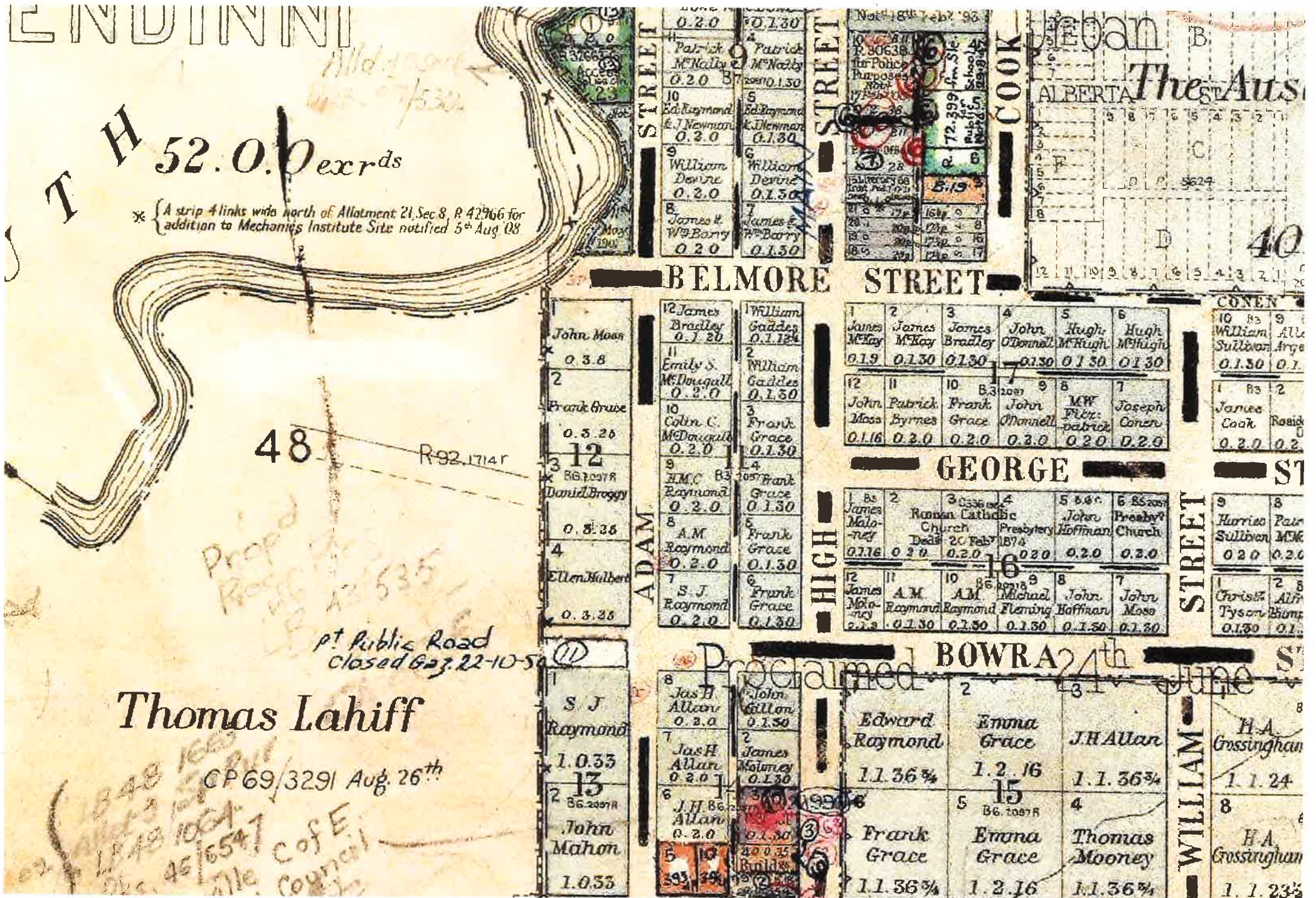



8.1.9

8

R92 1714 R.

2	Frank Grace	0.3.25
3	Daniel Broggy	0.3.25
4	Ellen Hulbert	0.3.25
5	S J Raymond	0.3.33
6	John Mahon	

ADAM

10	Colin C McDiarmid	0.2.0
9	HMC Raymond	0.2.0
8	A.M. Raymond	0.2.0
7	S.J. Raymond	0.2.0
8	Jus H. Allan	0.2.0
7	Jus H. Allan	0.2.0
6	J H Allan	0.2.0

3	Frank Grace	0.1.30
4	Frank Grace	0.1.30
5	Frank Grace	0.1.30
6	Frank	0.1.30
3	John Gillon	0.1.30
2	James Moloney	0.1.30
3	James Moloney	0.1.30

HIGH

12	John Patrick	0.1.16
11	James A.M. Raymond	0.1.30
12	James Moloney	0.1.16
11	A.M. Raymond	0.1.30
12	Edward Raymond	1.1.36
16	Frank Grace	

R.3894 M4A

Proclaimed

Regional

... for purposes other than under the reservation from sale under general notice of 17th April, 1862, revoked 11th May, 1923.

All lands dedicated as State Forests, Timber Reserves and Flora Reserves under the Forestry Act, 1916, 1949, proclaimed districts under the Fauna Protection Act, 1948, Gazette 2nd February, 1951.

No tree situated within, or within one chain of the bed or bank of any river or lake or section of a river as prescribed (see notifications Gazette 9th Apl, 1948, 30th Sept., 1949, 30th May, 1952 and 17th June, 1960) shall be ringbarked, cut down, felled or destroyed except with the permission of the Forestry Commission Sec. 26D. Water Act, 1912-1955.

Police Offences:  
(identical w

Valuation of L  
Nambucca Shire.

Ø Sec. 8: 19-1-11. - Rds. 09-1054.

Ø also for all streets and lanes within the suburban boundaries of Village Bowrav

Reference      Notes.

<u>Nº</u>	<u>PAPERS.</u>	<u>REMARKS.</u>
1.	R 32 - 693.	J. Lahiff objection to closure of Belmore
2.	R. 37 - 1230.	Enquiry by Nambucca S.C. re public gates
3.	R. 53 - 1077	Closure of Cook St. for road site

